

ITEM NO.	PART NUMBER	DESCRIPTION	MATERIAL	DRAWING #	QTY.
1	AD-5000-12	12FPx12FP PIPE COUPLING		STOCK	1
2	AD-STREET 45 .75	ELBOW, 3/4" 45 DEG. STREET	MATERIAL	STOCK	1
3	BO-3/8x1/2 HCS	BOLT 3/8 x 1/2		STOCK	1
4	BO-3/8 FLW NUT	FLANGE WELD NUT 3/8		STOCK	1
5	BO-.375 FWS SEALING	FLAT WASHER 3/8 SEAL		STOCK	1
6	FP-AD5X125	ADAPTER, SUCTION BARB, RESERVIOR		10-2303	1
7	FP-RV41239B	HYDRA BED, OIL RESERVOIR	RECT. TUBING 4x12x3/16	10-2301	1
8	HD-MAG RES 820	MAGNET MA-820	MAGNET	STOCK	2
9	MI-CAPLUG 13X	PLUG, HB RES. SUCTION		STOCK	2
10	RV-FILL NECK	RESERVOIR FILL NECK	-	95-2224	1
11	MI-CAPLUG 12X	PLUG, HB RES. RETURN		STOCK	1
12	FP-RV41239-BEC	OIL RESERVOIR 4.125 x 12 x 39" BROKE END CAP	7ga HRS.	11-2306	2
13	FI .125 X 3.5 L 6	BAFFLE, RESERVOIR, HYDRABED	FI 1/8 X 3-1/2	11-2321	1

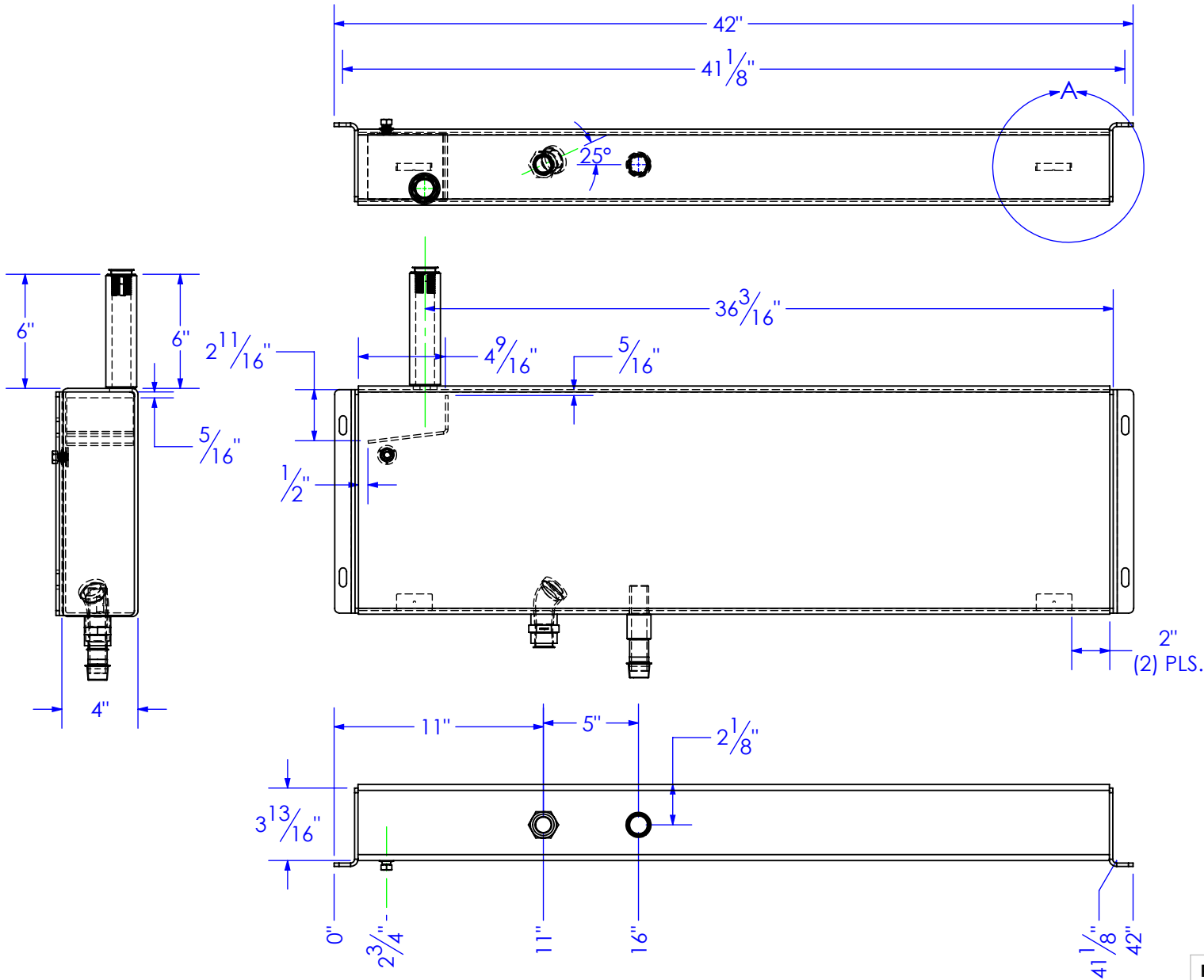

SUB-RESERVOIR IS A SUBASSEMBLY OF **RE-AS-RV41239**
ADD ONE MIAWC-5750-03, MI-CAPLUG 13X & MI-CAPLUG 12X
TO MAKE A COMPLETE ASSEMBLY

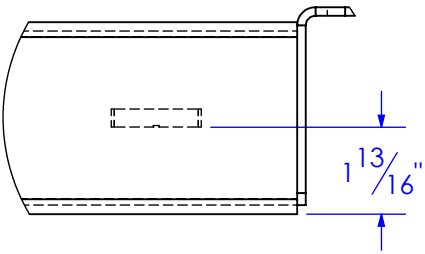

DETAIL A
SCALE 1 : 4

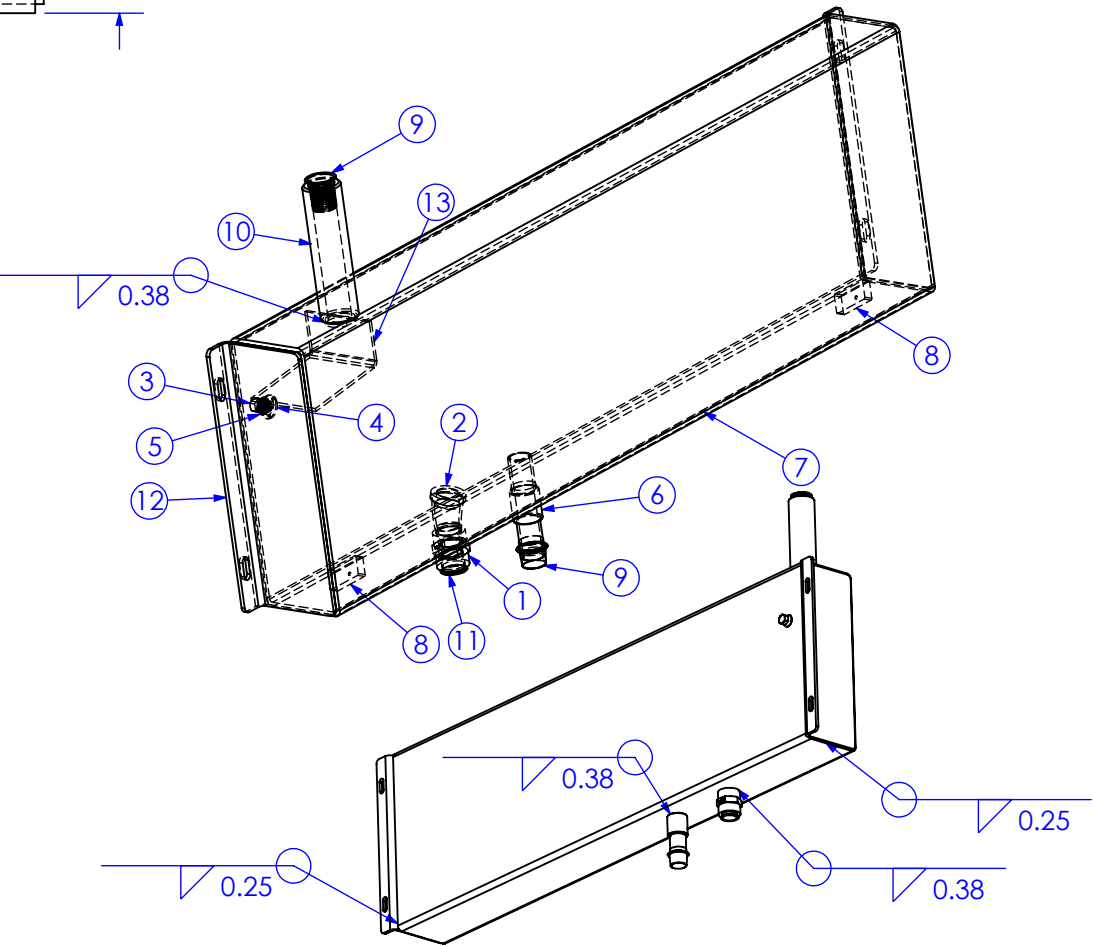

- NOTES:
1. INSIDE OF RESERVOIR MUST BE FREE FROM CONTAMINATION.
 2. PLUGS MUST BE INSTALLED FOLLOWING TESTING TO PREVENT CONTAMINATION.
 3. TEST PROCEDURE:
INSTALL PLUGS INTO FILLER NECK & 3/4" COUPLER. APPLY 7 PSI AIR INTO 1" COUPLER. SPRAY ALL WELDS WITH SOAPY WATER & CHECK FOR LEAKS. INSTALL ITEMS 3, 5, 12, 13, 14.
 4. INSTALL HD-MAG RES 520 PRIOR TO WELDING FP-RV41239B 3XX0 IN PLACE.

PROPRIETARY AND CONFIDENTIAL
THE INFORMATION CONTAINED IN THIS
DRAWING IS THE SOLE PROPERTY OF HYDRA-
BED. ANY REPRODUCTION IN PART OR
AS A WHOLE WITHOUT THE WRITTEN
PERMISSION OF HYDRABED IS PROHIBITED.

UNLESS OTHERWISE SPECIFIED:
DIMENSIONS ARE IN INCHES
TOLERANCES:
FRACTIONAL $\pm 1/16$
ANGULAR: MACH ± 1 BEND \pm
TWO PLACE DECIMAL ± 0.10
THREE PLACE DECIMAL ± 0.05
MATERIAL
DO NOT SCALE DRAWING

NAME	ETHAN	DATE	11/16/2020
DRAWN	ETHAN		
PART #	SUB-RESERVOIR		
ASM #	BOLT-IN		
COMMENTS:	BARE OIL RESERVOIR BOLT IN 4x12x39"		

P.O. BOX 248, SABBETHA, KS 66534 (785) 284-3674 FAX (785) 284-3931		SCALE: 1:8		WEIGHT: 75.67	SHEET 1 OF 1	
SIZE		DWG. NO.		REV		
B		11-1303		E		